

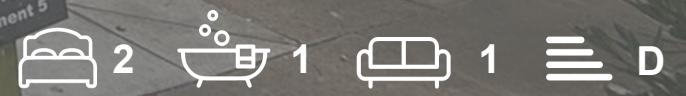

3 Beverley House, Maple Court Main Street  
Fulford, YO10 4QG  
**£895 PCM**

Reserved Parking  
Apartment 5

2 1 1 D



A row of four white icons on a dark background: a bed icon, a bathtub icon, a sofa icon, and a menu icon (three horizontal lines). To the right of the menu icon is a white letter 'D'.

**MODERN APARTMENT IN FULFORD -  
QUIET LOCATION - ALLOCATED  
PARKING.**

This ground floor two bedroom apartment has become available to rent in the popular area of Fulford. As you enter into the property you will find a spacious living and dining area. Further along the hallway you will find a modern kitchen and three piece bathroom suite. Finally there is one double bedroom and one single bedroom, which would be perfect as an office space.

Convenient for York City centre and the A64, the property would be perfect for a professional couple or individual.

The property is to be let on an unfurnished basis.

Council Tax Band C

EPC Rating D





# FLOOR PLAN

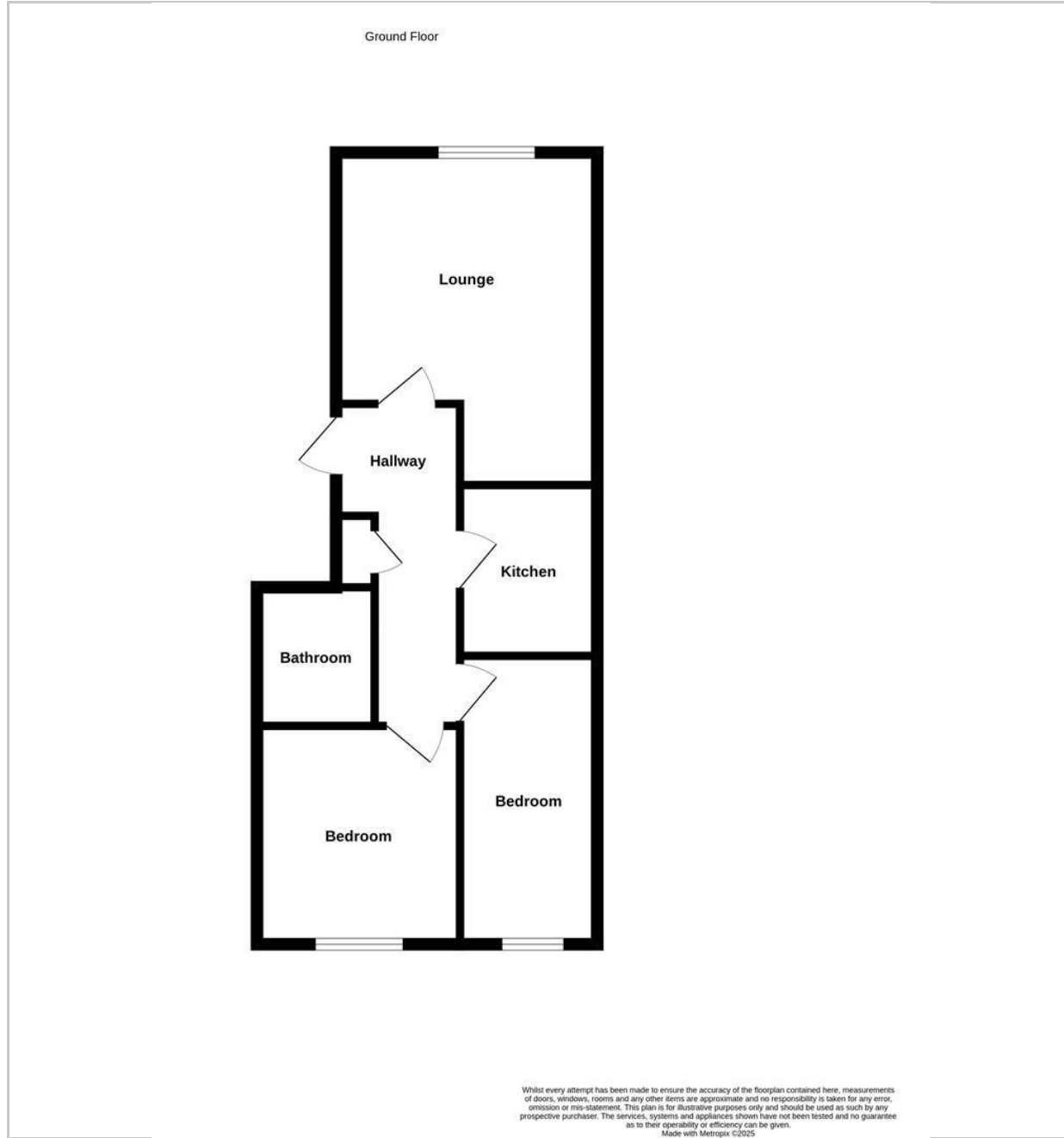

# LOCATION

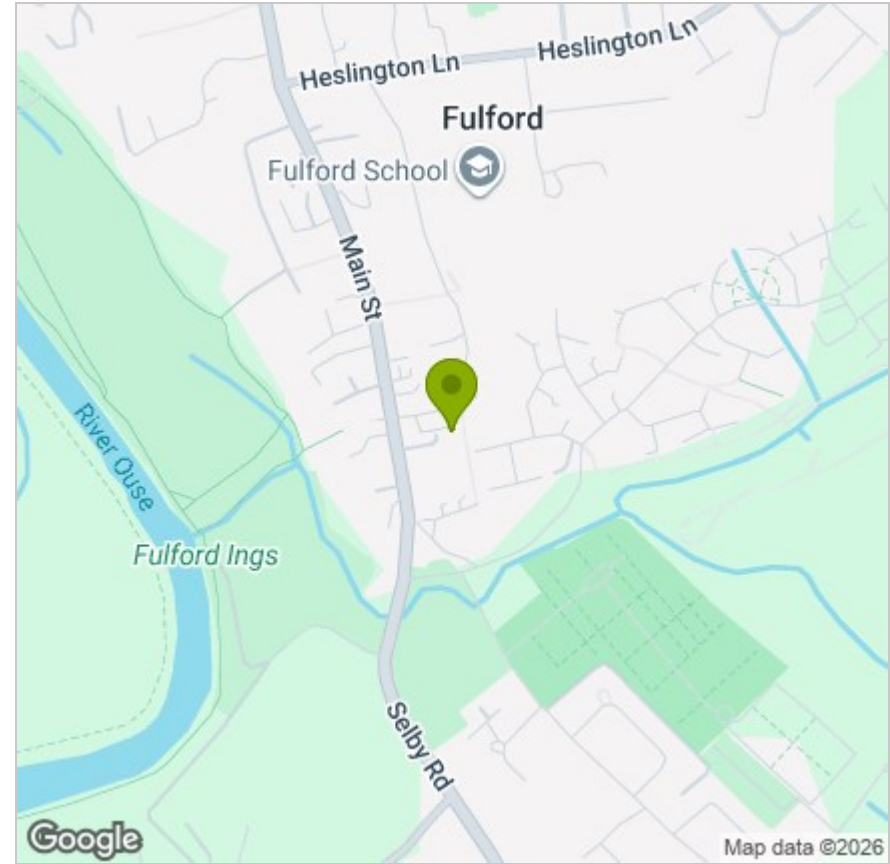

# EPC

Energy Efficiency Rating		Current	Potential
Very energy efficient - lower running costs			
(92 plus) <b>A</b>			
(81-91) <b>B</b>			
(69-80) <b>C</b>			
(55-68) <b>D</b>		<b>60</b>	<b>61</b>
(39-54) <b>E</b>			
(21-38) <b>F</b>			
(1-20) <b>G</b>			
Not energy efficient - higher running costs			
<b>England &amp; Wales</b>		EU Directive 2002/91/EC	

These particulars, whilst believed to be accurate are set out as a general outline only for guidance and do not constitute any part of an offer or contract. Intending purchasers should not rely on them as statements of representation of fact, but must satisfy themselves by inspection or otherwise as to their accuracy. No person in this firm's employment has the authority to make or give any representation or warranty in respect of the property.